

Issue 47 | February 2020

BY DESIGN



Excellence in Golf Design from the American Society of Golf Course Architects

Top-tier designs

Special edition for the eighth annual ASGCA Design Excellence Recognition Program

How much

» WATER

» LABOR

» MONEY

**could your facility
save with a Toro
Irrigation System?**

LET'S FIND OUT.



Toro.com/irrigation

Striving for excellence

Welcome to this special edition of *By Design*, devoted to the eighth annual Design Excellence Recognition Program from the American Society of Golf Course Architects.

Each year we work with a panel of golf industry leaders, including representatives of the Club Managers Association of America, Golf Course Builders Association of America and Golf Course Superintendents Association of America, to select projects that represent design excellence and highlight the innovation and problem-solving skills required to create successful golf facilities.

This year, six facilities have been honored by the program, each of which are profiled on the following pages. We have an eclectic mix of projects from new 18-hole layouts to practice facilities and a putting course.

Whether it's creating a new design that will be playable and challenging for PGA Tour players and everyday golfers alike, or designing a short game area so that golfers can practice safely, the quality of work demonstrated by ASGCA members at golf clubs across the world is second to none. One of the main goals of the Design Excellence Recognition Program is to share examples of best practice, so that owners and operators of all golf facilities can learn from others before making plans to improve their own courses.

I hope you are able to find some inspiration from the stories on the following pages, and that you enjoy this special edition of *By Design*.



Jan Bel Jan, ASGCA
President
American Society of Golf Course Architects

BY DESIGN

Editor and Publisher: Toby Ingleton

Editorial contributors: Richard Humphreys

Design: Bruce Graham, Libby Sidebotham

ASGCA Staff: Chad Ritterbusch; Mike Sheffy; Aileen Smith; Marc Whitney

Photography: Arnold Palmer Design Company; Diamante Cabo San Lucas—Gerardo Arias; Raymond Hearn, ASGCA; Russell Kirk; University Club of Milwaukee; Dave Sansom; Art Schaubeter, ASGCA; Devin Sena; Spence Golf Design; TPC Colorado

Subscribe to *By Design* at www.tudor-rose.co.uk/bydesign

© 2020 American Society of Golf Course Architects. All rights reserved. www.asgca.org

By Design is sponsored by:



CONTENTS

Meet the designers 5

Introducing the golf course architects responsible for the projects highlighted by the latest ASGCA Design Excellence Recognition Program.

Bay Hill Club & Lodge 6

A new practice facility for this famous PGA Tour venue.

Diamante Cabo San Lucas 8

New 'Dunes' putting course for the highly-regarded Mexican resort.

Maple Lane Golf Club 10

Comprehensive redesign helps club deal with water issues.

McLemore Club 12

Two ASGCA members collaborate to create new Highlands course.

TPC Colorado 14

New course is playable for pros and everyday golfers alike.

University Club of Milwaukee 16

State-of-the-art practice facility includes four-hole short course.

COVER

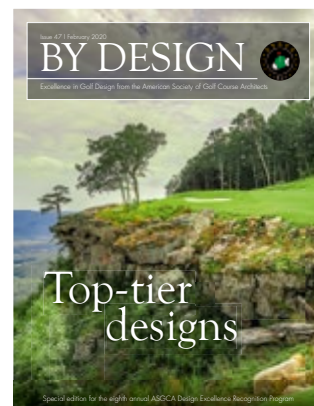

McLemore Club in Georgia, designed by ASGCA Past President Rees Jones and Bill Bergin, ASGCA. Photographed by Dave Sansom.

CONNECT TO

Upcoming technologies

Simplified upgrades

A partner dedicated solely to irrigation

THE FUTURE



"There are always upgrades coming out and nobody wants to feel left behind. If I can do just a quick upgrade and keep using what I already have, that feels great, and Rain Bird allows us to do that."

Stephen Rabideau, CGCS | Director of Golf Courses, Winged Foot Golf Club

Discover the benefits of a Rain Bird system at rainbird.com/TheFuture.



RAIN BIRD®

Meet the designers

Eight ASGCA members have led projects at the clubs highlighted by this year's Design Excellence Recognition Program.



Brandon Johnson, ASGCA, and Thad Layton, ASGCA, are the principal golf course architects at Arnold Palmer Design Company.

Read about their new short game area for Bay Hill Club & Lodge on page 6.



Bill Bergin, ASGCA, competed in more than 50 PGA Tour events before becoming a golf course architect. ASGCA Past President Rees Jones has designed or redesigned over 200 golf courses during his career.

Read about their collaboration on the new Highlands course at McLeMORE Club on page 12.



Paul Cowley, ASGCA, is president of Linkland Inc., a land planning, architectural and golf course design company.

Read about his design for the new Dunes putting course at Diamante Cabo San Lucas on page 8.



Art Schaupter, ASGCA, has over 25 years experience in golf course architecture.

Read about his design of the new TPC Colorado course on page 14.

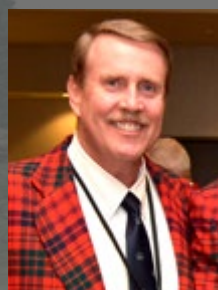

Raymond Hearn, ASGCA, has been running his own golf course design company for over 20 years.

Read about his redesign of Maple Lane Golf Club on page 10.



Andy Staples, ASGCA, helped to form Staples Golf Design in 2002.

Read about his new state-of-the-art practice facilities for the University Club of Milwaukee on page 16.



Practice made perfect

A new practice area at Arnold Palmer's famous PGA Tour venue in Florida is designed to enable golfers to hone a wide variety of short-game skills.

The short game area at Bay Hill Club & Lodge near Orlando, Florida, was previously quite small for a club that hosts an annual PGA Tour event, providing golfers with limited opportunities to safely practice anything more than chips and bunker shots.

With no land available adjacent to the practice area, opportunities for expansion were non-existent without reconfiguring another component of the Bay Hill property.

Arnold Palmer Design Company's Thad Layton, ASGCA, and Brandon Johnson, ASGCA, oversaw a project that would give the club a short game area that matched its reputation.

"To make room for the new amenity, we truncated Bay Hill's twenty-seventh hole [the ninth on its Charger nine] from 467 to 308 yards, building a completely new, drivable par four that is the first of its kind on the property," says Layton. "This shift freed up two acres of prime ground adjacent to the clubhouse that was reshaped into a robust short game practice area featuring four greens, seven bunkers, swales, and equal parts rough and fairway."

The area they designed allows golfers to replicate every shot they could expect to hit inside 100 yards on the Bay Hill course, with enough space for 20 golfers to practice safely.

Each of the four greens, the largest of which is 12,000 square feet, differ in style and size. They are complemented by bunkers that also have different characteristics, as described by Layton: "A 'splash' bunker for practicing downhill shots, a bunker with variable depths of three-to-six feet, a revetted 'Road hole' style bunker, a steep-faced and flat-bottomed bunker built in the Raynor/Banks style, a large but relatively-shallow teaching bunker, a small pot bunker, and a fairway bunker to practice longer shots."

Bay Hill is also using its new short game area to test different grass types and bunker liners for future use on its championship course.



The new short game area at Bay Hill Club & Lodge includes four greens and several bunkers of varying styles and sizes



Photos: Arnold Palmer Design Company

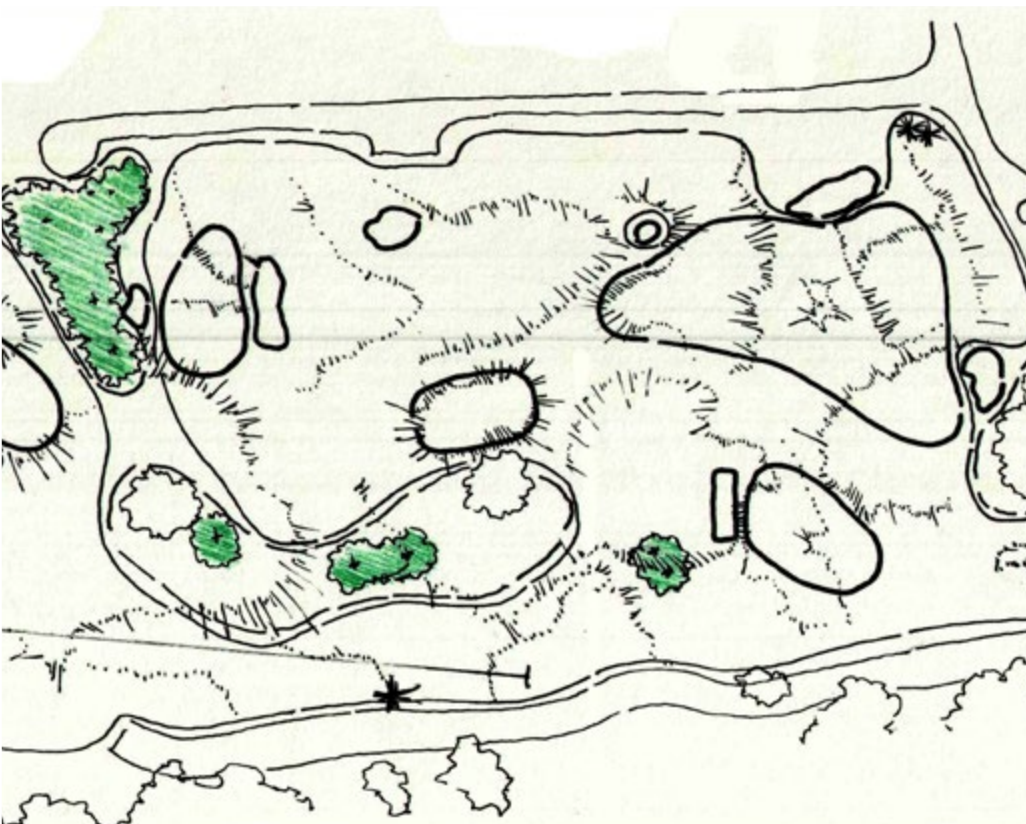

BAY HILL CLUB & LODGE

Location:

Orlando, Florida

Golf course architect:

Thad Layton, ASGCA, and
Brandon Johnson, ASGCA
www.arnoldpalmerdesign.com

Project summary: The previous short game practice area was limited in size. The ownership and members wanted a larger variety of shots up to 130 yards. Arnold Palmer Design Company achieved this by shortening the ninth on the Charger nine, which opened up two acres for the development of a complete short game complex.

Partners: Double Eagle Golf Works (golf course builder); Leibold Irrigation; Rain Bird (irrigation); Tony Altum (irrigation consultant); Capillary Concrete (bunker liner); Polyplast (bunker liner); ZLine Bunker Systems (bunker liner); Perma-Edge (edging)

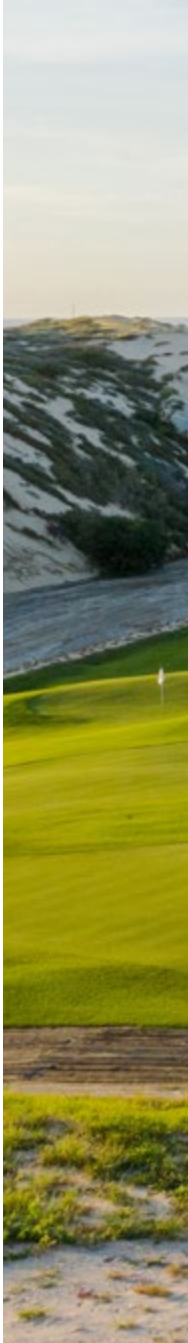

Putting in style

A new 15-hole reversible putting course provides guests at a Mexican resort with a fun golf facility that caters for families and friends.

The operators of Mexican resort Diamante Cabo San Lucas turned to Paul Cowley, ASGCA, to create a putting course that would join its other golf offerings: the 18-hole Dunes and El Cardonal courses and Oasis short layout.

The new putting course is located next to the clubhouse and the first tee of the Dunes course—which Cowley co-designed with professional golfer Davis Love III and his brother Mark Love. “It occupies three acres of turf and is built on what was the second half of the original eighteenth hole,” says Cowley. “It enjoys some of the best views and vistas of the golf complex and also serves as an event and activity lawn area.”

The 15-hole putting course totals 507 yards, and is made up of three par-two holes and 12 par threes, for a total par of 42. Holes vary in length from 14-to-64 yards.

“The course is laid out in a continuous loop of grass cut at green height, and the surrounding turf is cut at a fairway height,” says Cowley. “There’s 25 feet of elevation change on the course, and the turf is Seaside Paspalum.. Each of the 15 pinnable areas are big enough for three-to-five pin locations. The greens are cut to a stimp speed of between nine and 10.”

Designed to play in both directions, the course has a total of 30 different hole configurations—a downhill hole one day becomes an uphill hole the

next, with the numbered flags reversed on alternate days. Players tee off one flag length away from either side of the previous cup, and perpendicular to the centerline of play. Play starts and finishes at the fifteenth flag.

The 15-hole layouts are named East and West, corresponding to the direction that the first hole is played into. A scorecard details both courses and a handicap rating for each hole, which allows players of different skill levels to compete.

“Opened in 2019, the new putting course has been very successful,” says Cowley. “It appeals to players wanting to play more after a round, beginners of all ages, husbands with wives and entire families. From the amount of



Photos: Diamante Cabo San Lucas – Gerardo Arias

The new 15-hole putting course at Diamante Cabo San Lucas in Mexico plays in alternate directions from one day to another

beverage cups picked in the mornings, it might bode well to have it lit at night! It is a challenging course to shoot par on, even for the better players.”

DIAMANTE CABO SAN LUCAS

Location:

Cabo San Lucas, Mexico

Golf course architect:

Paul Cowley, ASGCA
www.paulcowleygolf.com

Project summary: A new reversible putting course that doubles as an event lawn has been created for the Diamante Cabo San Lucas resort in Mexico.

Partners: Diamante Special Projects (shaping and greens construction); Toro (irrigation); Pikes Creek Nursery (turfing)





A sustainable design

A complete redesign of a 54-hole Michigan facility helps improve water management, while also freeing up land for real estate and additional amenities.

Maple Lane Golf Club in Sterling Heights, Michigan, regularly suffered from flooding after large rain events. It was susceptible to drought too, during which the course would run short of irrigation water.

The existing layout's failure to capture rainwater led the club to hire Raymond Hearn, ASGCA, to deal with these issues and maximize the potential of the club through new golf and non-golf amenities.

The owners wanted a unique golf course in the floodplain, and it was decided that a new master plan would be the best way to provide future economic, environmental and cultural sustainability for the club. They

also wanted new golf and non-golf amenities that would appeal to people of all ages, skill levels and cultures.

By reducing the number of holes from 54 to 27, Hearn was able to meet all these requirements, and create a new 18-hole golf course with a six-tee system, making it appealing and playable for golfers of all skill levels.

Hearn worked with engineers to develop a stormwater retention and detention network on the golf course that maximizes the capture of rainfall for irrigation, while also increasing floodplain storage capacity.

"I also recommended disease-resistant and low water-use turfgrasses throughout the golf course," says Hearn. "The new irrigation system will

use less water through an advanced system that will apply the exact and minimal amount of water to specific turfgrass areas. My environmentally-sensitive design will require less water, fertilizer and pesticide use."

Hearn included a new nine-hole par-three course within the master plan. Some holes lie within the floodplain and are designed to store water during flood events. The area can also be lit to allow for play during the evenings.

Areas have been identified for non-golf recreation such as bocce ball, pickleball, tennis and swimming, and there are now also residential opportunities on the property.

"Our goal is environmental, economic and cultural sustainability for this

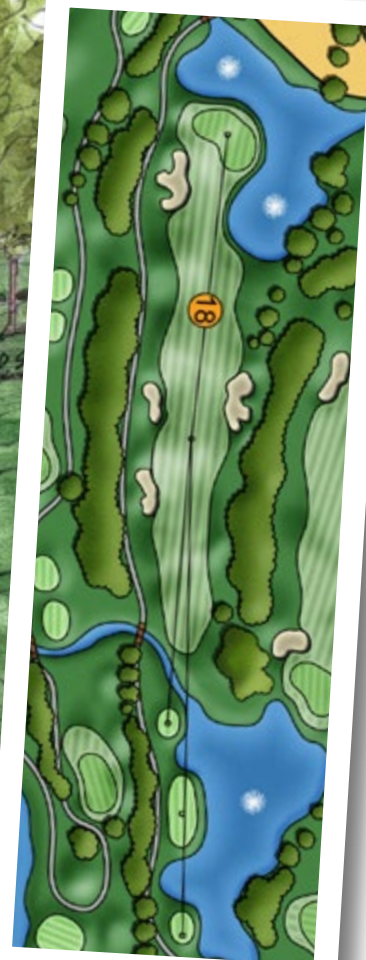

A sketch of the dramatic new eighteenth hole shows a green enveloped by one of the lakes on the Maple Lane property

entire development,” says Hearn. “Sterling Heights is a renaissance city with a wonderful blend of people from many different cultures who will all enjoy this very unique development.”

MAPLE LANE GOLF CLUB

Location:
Sterling Heights, Michigan

Golf course architect:
Raymond Hearn, ASGCA

Project summary: The redesigned course has more floodplain storage capacity and stormwater capture for irrigation and a lower overall maintenance requirement.

Partners: Giffels Webster (engineers and land planners); Toro (irrigation)



Images: Raymond Hearn, ASGCA



High drama

Architects collaborate to transform course on Lookout Mountain in Georgia, with a dramatic new eighteenth hole perched on the edge of a cliff.

The creation of the new Highlands course at McLemore Club in Rising Fawn, Georgia, is the result of a collaboration between Bill Bergin, ASGCA, and ASGCA Past President Rees Jones.

Their brief was to transform the former Canyon Ridge golf course, built on dramatic topography along the eastern brow of Lookout Mountain, to take advantage of all aspects of the property, making it more exciting but also more playable for members and resort guests.

"After walking the hiking trails along a rock-faced cliff and obtaining topographic information by hand, we determined that it was possible to

shift the eighteenth hole east 400 feet and drop it down over 100 feet to the edge of practically a sheer drop above McLemore Cove," says Bergin. "The site was strewn with massive boulders and two large ravines, but there was enough width for the fairway and green site."

Seven acres were cleared and burned as the site proved too difficult to access to haul timber away. Minimal blasting was necessary to create a workable set of tees and all excavated rock was utilized to build up and level one side of the fairway. "The owner gave us the opportunity to use a spectacular part of the property to create one of the most dramatic

finishing holes in golf," says Jones. "The hole may become one of the most photographed in the Southeast."

The area previously assigned to the clubhouse lacked space and missed out on the incredible views available throughout this property. After discussions that included both the design teams and developer Scenic Land Company, the clubhouse was moved to the edge of the old eighteenth hole. "Its elevation, along with selective tree removal, has created quite the spot to look over the new eighteenth and McLemore Cove," says Bergin.

A six-hole short course, the Cairn, was added, adjacent to the clubhouse on the old eighteenth fairway.



The dramatic new closing hole (left) at Mclemore Club, designed by Bill Bergin, ASGCA, and ASGCA Past President Rees Jones



Photos: Dave Sansom

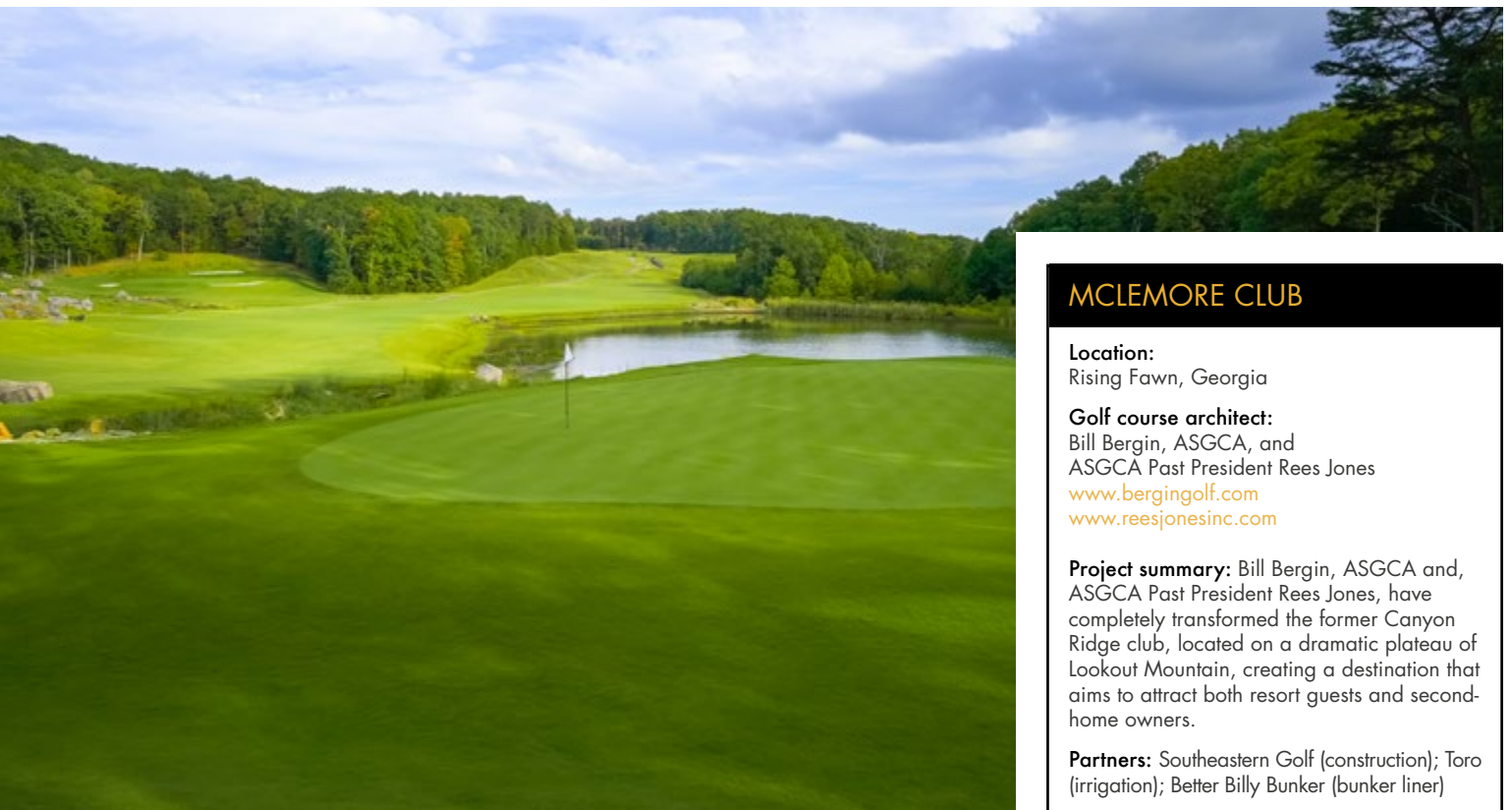

MCLEMORE CLUB

Location:

Rising Fawn, Georgia

Golf course architect:

Bill Bergin, ASGCA, and
ASGCA Past President Rees Jones

www.bergingolf.com

www.reesjonesinc.com

Project summary: Bill Bergin, ASGCA and, ASGCA Past President Rees Jones, have completely transformed the former Canyon Ridge club, located on a dramatic plateau of Lookout Mountain, creating a destination that aims to attract both resort guests and second-home owners.

Partners: Southeastern Golf (construction); Toro (irrigation); Better Billy Bunker (bunker liner)



Designed for all

With wide fairways and tees ranging from just over 4,000 to nearly 8,000 yards, TPC Colorado is playable for the everyday golfer as well as PGA Tour professionals.

Art Schaupeter, ASGCA, was hired by developer Heron Lakes Investments to create a new 18-hole golf course that would work as the centerpiece of an 800-acre master-planned community. The owners also reached an agreement with the TPC Network for the course to join the chain operated by the PGA Tour and to host a top-tier professional golf tournament.

Hosting a PGA Tour event added multiple new considerations for the design of the course, including how best to accommodate spectators, hospitality tents, parking and other items of event infrastructure.

But keeping everyday golfers at the forefront of his thoughts, Schaupeter designed TPC Colorado with seven

sets of tees—playable from 4,157-7,991 yards. Greens vary in size, from 5,000-11,500 square feet, and have been designed so that there are plenty of pin positions available. Width was also important for his design. There are 55 acres of fairway which are upwards of 60-70 yards wide on many holes. “It enhances playability by minimizing the potential for lost balls and helps to speed up play,” says Schaupeter.

“The wide fairways create a larger range of potential angles of approach to the green, which, when combined with the diversity of shapes, sizes and contouring of the green surfaces, will add to the daily variety and interest in play,” he adds. “The green surfaces have subtle breaks and plateaus that enhance the need to learn and

understand how best to approach them depending upon the hole location at the time. Much like the golf holes themselves, they are very individual in character.”

Schaupeter also incorporated a variety of bunker styles, including sod-walled hazards, for more strategic variety and interest.

“Put the golf in the golfer’s hands’ means creating a golfing experience in which the golfers discover the course for themselves, making active decisions on how they want to play each hole,” says Schaupeter. “This will provide a fun, engaging and adventurous experience for the golfer, putting them in a positive mindset throughout the round as they dictate and discover the golf on their terms.”



Photo: Russell Kirk

TPC Colorado is the first new course to open in the state for over ten years



Photo: Devin Sena



Photo: Devin Sena

TPC COLORADO

Location:

Berthoud, Colorado

Golf course architect:

Art Schaupeter, ASGCA
www.schaupetergolf.com

Project summary: Art Schaupeter, ASGCA, was given the task of creating a golf course that is a fun, engaging golfing experience for recreational players during 51 weeks of the year, but also a challenging and entertaining PGA Tour-caliber tournament venue for the other week.

Partners: Oliphant Golf (contractor); Toro (irrigation); Brian Keighan (irrigation design); Jackson Seed Varieties (grass); Profile Products (hyrdomulch)



A change in approach

A new state-of-the-art practice facility and tie-in with Marquette University helps Milwaukee-area club stand out from its competitors.

Formerly known as Tripoli Country Club, and home to a course originally designed by Tom Bendelow, the University Club of Milwaukee in Wisconsin was in need of improved practice facilities.

The course—which still contains many of the classic Bendelow features, such as 16 original greens—once hosted the Miller Open and the Greater Milwaukee Open.

Nevertheless, the club's only other offering was a short and narrow practice range that amounted to little more than a warm-up area. This put the club at a disadvantage with regards to membership recruitment and ultimately, revenue generation. With competition among other private

clubs in the area near all-time highs, a change in approach was needed.

The member-owned club expanded its network to partner with Marquette University's men's golf team, and engaged Andy Staples, ASGCA, to create a golf facility master plan, which revolved around increasing the much-needed practice offerings.

The result was the development of a parcel of unused land and some redesign work on three holes to make space available for the creation of a new, state-of-the-art practice facility.

“By capitalizing on a 10-acre parcel of undeveloped forest terrain in the center of the property, modifying the tees on the thirteenth and sixteenth, as well as completely rebuilding the twelfth hole,

the grand vision for the new practice facility came to life,” says Staples.

“Fortunately for the U Club, the largely-intact original design of the course offered a compelling experience and historic story to help distinguish it in the area. So, with a state-of-the-art practice facility, the club would truly stand out amongst its competitors.”

Within the practice area Staples created a short, four-hole course with a design to match the Tom Bendelow features of the course. The area also includes a new putting green and a competition wedge range where golfers can practice a range of shots up to 120 yards in length, from sand and grass bunkers and from various lies on both fairway and rough grass.



Photos: University Club of Milwaukee

A new par-three twelfth hole (left) was designed to make room for much-improved practice facilities at University Club of Milwaukee



Image: Staples Golf Design



UNIVERSITY CLUB OF MILWAUKEE

Location:

Milwaukee, Wisconsin

Golf course architect:

Andy Staples, ASGCA

www.staplesgolfdesign.com

Project summary: The University Club of Milwaukee was lacking adequate practice facilities, so the member-owned club decided to partner with Marquette University's men's golf team and Andy Staples, ASGCA, to create a state-of-the-art practice facility to increase competitive appeal, revenue and membership value.

Partners: Marquette University; Golf Creations (construction); Eric Christensen Design (irrigation consultant); Brian Mavis (agronomy); Reindeers, Inc. (seed, amendments and materials)

Get to the Root of Your Course Renovation.

In the Ground

Profile Porous Ceramics (PPC) is the #1 inorganic amendment chosen for greens renovations and has been used on more than 1,000 courses, including many of the U.S. Top 100.

On the Ground

Profile offers FREE testing of soil, sands and trial mixes, and its agronomists are available to provide mix design recommendations and consultation.

By Your Side

Only Profile provides complete on-site project support through the entire renovation process.

"I've grown in greens on both straight sand and peat moss. What you get visually with PPC is terrific, not just in year one, but even after year two and three. I wouldn't go down without a fight trying to convince someone building a new golf course to really look into using Profile."

- Eric Bauer, Director of Agronomy, Bluejack National

Contact us for your **FREE**
on-site consultation and soil test.

ProfileGolf.com

Call (800) 207-6457 and ask to speak to a Profile Golf Business Manager.



SPONSORS



By Design would not be possible without the support of its sponsors, who have played a key role in the publication of this magazine.



Profile Products manufactures a comprehensive line of soil modification, erosion control and turf establishment products. Its experienced team takes a consultative approach with golf course architects, builders and superintendents to design and specify customized solutions for maintenance and construction.

Profile's team designs root zone mixes utilizing Profile Porous Ceramics to meet USGA guidelines. Its ceramics permanently modify the root zone to better conserve water and retain nutrients.

Profile's complete line of hydro-seeding products is the leading specified brand by golf course architects. Profile works with architects and project managers, establishing effective erosion control and vegetative establishment practices.

www.profileproducts.com



Since 1933, Rain Bird has built a reputation on delivering irrigation systems that combine performance with efficiency. Rain Bird leverages state-of-the-art technologies to innovate and develop products that apply water in the most effective and efficient manner possible.

From highly-efficient sprinkler nozzles to cutting-edge control systems and pump stations, Rain Bird is widely recognized as the leader in golf course irrigation control system technology. We take the challenge of using water responsibly very seriously. That's why our over-arching philosophy, *The Intelligent Use of Water™*, guides everything we do. The revolutionary Integrated Control System™ provides innovation at a lower overall cost to golf courses enabling the user to maximize system efficiency and conserve water with a smaller environmental footprint.

For more information, please contact 1-800-RAINBIRD or visit:

www.rainbird.com



The Toro Company is proud of its legacy of quality and innovation. Customers around the world rely on Toro for high performing products that include precision fairway and rough mowers, greens mowers, compact utility loaders, commercial zero-turn mowers, bunker management machines, and water-efficient irrigation systems.

In 1921, Toro developed the first fairway mower and six years later shipped the company's first golf maintenance products overseas. Today Toro continues to lead the global market with best-in-class turf maintenance equipment and precision irrigation solutions. Approximately two-thirds of the top 100 courses in the world use Toro irrigation systems. The company also leads the way in environmental innovations, making products safer, cleaner and quieter whenever possible.

www.toro.com

ASGCA LEADERSHIP PARTNERS



Supporting Education in the Golf Course Industry

ASGCA thanks the following companies for their continued support of golf course development and renovation—helping ASGCA members do their jobs better, for the good of the game.

MAJOR LEVEL PARTNERS



MERIT LEVEL PARTNERS



SPONSORS

